

UNIVERSIDAD LOYOLA

SEVILLA | CÓRDOBA

EXCHANGE STUDENT FACTSHEET 2026-27



Universidad
LOYOLA

INCOMING@ULOYOLA.ES

WWW.ULOYOLA.ES

[@LOYOLAINTOFFICE](https://www.instagram.com/LOYOLAINTOFFICE)



GET TO KNOW US!

1
International Office

2
Our campuses

3
Academic Calendar

4
Nomination &
Application Process

5
Academic Offer

6
Language Requirements

7
Buddy Program

8
Student Clubs

9
Housing Options

10
FAQ

INTERNATIONAL OFFICE

BASIC INFORMATION

Name: Universidad Loyola Andalucía

Erasmus Code: ECORDOBA23

Director International Office: Dr. Mayte Lara

mlara@uloyola.es

Incoming Team

incoming@uloyola.es

Coordinator: Alejandra de Miguel

amiguel@uloyola.es

(+34) 957222100 (Ext. 2224)

Contact for Learning Agreements

Advisor: Theresa Messmer

tmessmer@uloyola.es

(+34) 957222100 (Ext. 2255)

OUR CAMPUSES

DOS HERMANAS, SEVILLA

Our Sevilla campus is located in the municipality of Dos Hermanas and can be reached by bus and metro. An architectural masterpiece and hub for science and innovation.

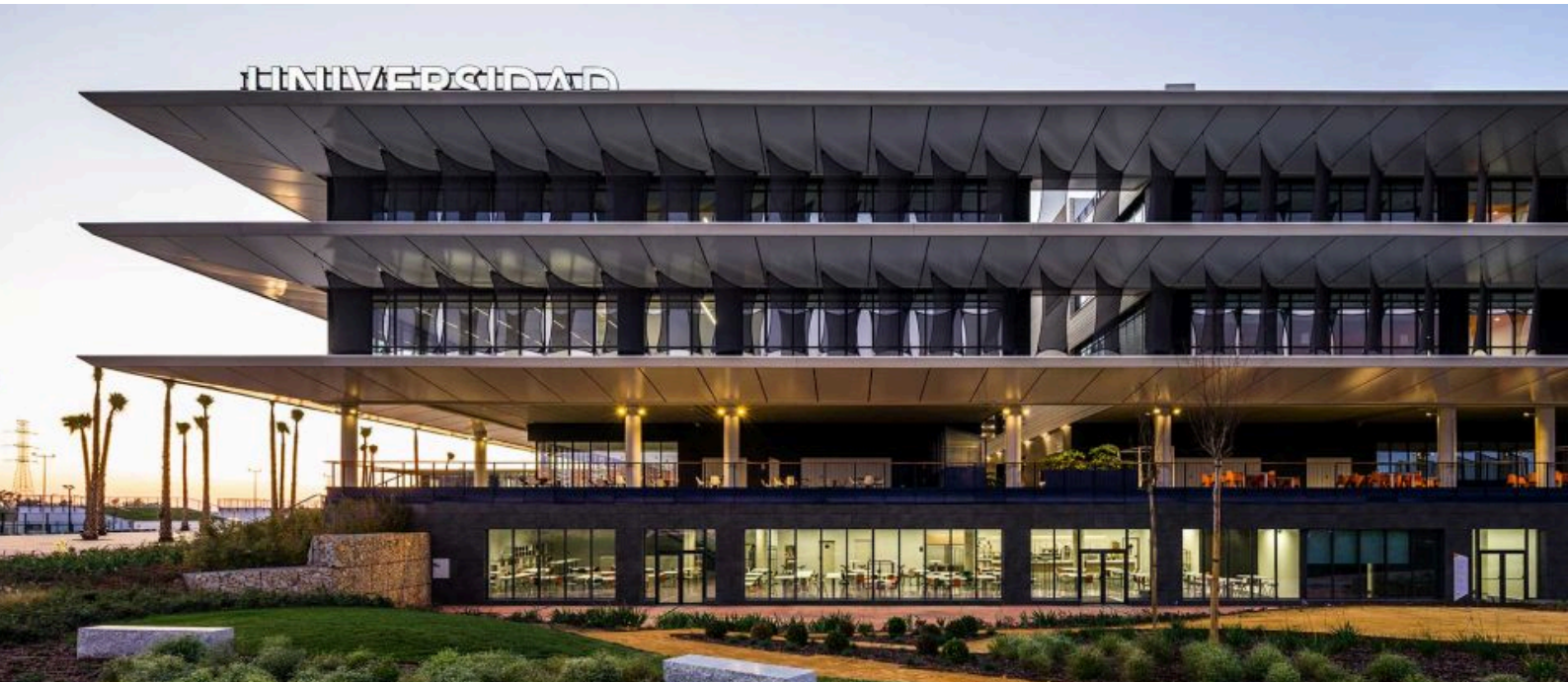

CÓRDOBA

With its close proximity to the student district and the historic center, there is no need for commuting! The campus also offers you many green areas to study underneath the sun and is known for its welcoming atmosphere!



ACADEMIC CALENDAR

FIRST SEMESTER

FALL

Welcome Week: 31 August - 4 September 2026

Beginning of classes: 7 September 2026

End of classes: 4 December 2026

Ordinary exams: 9 December 2026 - 12 January 2027

Extraordinary exams: 15 January - 30 January 2027

SECOND SEMESTER

SPRING

Welcome Week: 25 January - 29 January 2027

Beginning of classes: 1 February 2027

End of classes: 14 May 2027

Ordinary exams: 17 May - 5 June 2027

Extraordinary exams: 14 June - 26 June 2027

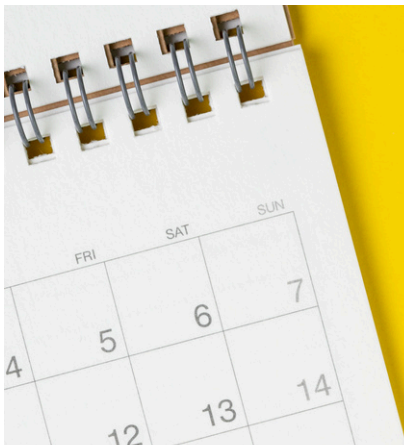

STUDY AT LOYOLA!

NOMINATION PROCESS

FOR UNIVERSITIES

The student will be nominated by the International Relations Office of their home university via our online system MoveON.

Students will need to be equally divided between our campuses, Córdoba and Sevilla, when their study program is available in both locations.

1ST SEMESTER - FALL / ANNUAL

15 FEBRUARY - 15 MAY

2ND SEMESTER - SPRING

15 SEPTEMBER - 15 NOVEMBER

APPLICATION PROCESS

FOR STUDENTS

Student nominations are revised by the International Office. Accepted students will receive their welcome letter.

To confirm their acceptance, all students need to complete the application process on time.

1ST SEMESTER - FALL / ANNUAL

01 MARCH - 1 JUNE

2ND SEMESTER - SPRING

1 OCTOBER - 30 NOVEMBER

ENROLLMENT

Accepted students receive instructions for course enrollment in July (for Fall) / December (for Spring).

At the end of the registration the student must pay 80€ to finalize the enrollment.



ACCIDENT ON CAMPUS INSURANCE
CIVIL LIABILITY INSURANCE
STUDENT CARD
TRANSCRIPT OF RECORDS

ACADEMIC OFFER

CÓRDOBA

SEVILLA



BUSINESS & ECONOMICS

- C** **S** Business Administration
- C** **S** Data and Business Analytics
- S** Economics



POLITICS & LEGAL SCIENCES

- C** **S** International Relations
- C** **S** Law
- C** **S** Criminology



COMMUNICATION & ARTS

- C** **S** Communication**
- C** **S** Advertising & Digital Marketing*
- S** Journalism & Digital Media*
- S** Audiovisual Communication*
- S** Performing Arts & Cinematography
- S** Music Production and Creation



ENGINEERING

- S** Applied Mathematics
- S** Mechatronics & Robotics Engineering
- S** Industrial Technologies Engineering
- S** Industrial Organization Engineering
- S** Computer and Virtual Technologies
- S** Electromechanical Engineering**
- S** Software Engineering*
- S** Video Game Creation and Digital Animation
- S** Aerospace Engineering*



HEALTH

- C** **S** Nursing*
- S** Pharmacy*
- C** **S** Physical Activity and Sports Sciences
- S** Biotechnology*
- S** Medicine*
- S** Physiotherapy*
- S** Nutrition*
- S** Biomedicine*



EDUCATION & PSYCHOLOGY

- S** Early Childhood Education
- S** Primary Education
- C** **S** Psychology

Degrees marked with * are newly incorporated and have not yet completed the full cycle of its program. Degrees marked with ** are in extinction: meaning that they are not going to be offered anymore in 26/27.

LIST OF COURSES FOR EXCHANGE STUDENTS INTERACTIVE COURSE CATALOGUE



Timetables

ECTS

Number of Credits



Language



Syllabus

LANGUAGE REQUIREMENTS

ENGLISH

B1 certificate will be mandatory if the student enrolls in classes in English. A specific language certification of exam type is not required. The certificate must be uploaded to the application form.

SPANISH

B1 certificate will be mandatory if the student enrolls in classes in Spanish. A specific language certification of exam type is not required. Additionally, some courses in our degrees may require a B2-C1 level of Spanish. The certificate must be uploaded to the application form.



LOYOLA IDIOMAS

SCHOOL OF LANGUAGES



PRE-EXCHANGE COURSE

205€

Virtual Spanish preparation course in July
20 Hours

EXTENSIVE COURSE

275€

Semester-long language course according to your level
3 ECTS for your TOR

INTENSIVE COURSE

FREE

Spanish language and culture course during the Welcome Week
10 Hours / 1 ECTS for your TOR

CULTURAL WORKSHOPS

190€

Learn all about the Spanish and Andalusian culture, arts literature, music, holidays and dance.
20 HOURS / 2 ECTS for your TOR

BUDDY PROGRAM

MAKE FRIENDS FOR A LIFETIME

A Loyola student will be assigned to each international student, they will help them not only with their arrival but also throughout the duration of their stay. The Buddies will organize fun cultural activities throughout the academic year to bring the students who stay with us closer to the Spanish and Andalusian culture.



LOYOLA CULTURE

**ECO GROUP
VOLUNTEERING
DEBATE
CREA LOYOLA: ARTS
THEATER
LOYOLA SI DO:
MUSICAL ENSEMBLE
CHOIR**

**BOOK CLUB
E-STARS: E-SPORTS
ASIA BRIDGE CLUB
INVESTMENT CLUB
FILM CLUB**



SPORTS



**TENNIS
HANDBALL
BASKETBALL**

**FOOTBALL
VOLLEYBALL
PADEL**





HOUSING

Students can choose an accommodation that works best for their needs. Whether it is sharing a flat with other students, a room in a university residence or immersing in a full experience with a host family.

CÓRDOBA

SOLRENT

SEVILLA

RESIDENCIA MICAMPUS
ENTRENÚCLEOS

More information on housing: incoming@uloyola.es

HOST FAMILY write to amiguel@uloyola.es.



Be careful with internet scams. If you have any doubts, please send us an email to incoming@uloyola.es.

LOYOLA FAQ'S



Can students take courses from different areas of study?

Yes, but the student will need to comply with prerequisites in each course. Please check the syllabus.

Are classes taught bilingually?

No, there are classes in Spanish and classes in English. The student will need to enroll in the classes that they are able to follow and present the exams in the corresponding language.

Can students take master courses?

Undergraduate programs in Loyola are 4 years long. Master students from other universities are advised to take 3-4 year courses. Our Master programs are not open to receive exchange students.

Do you send exams to be done at the home university?

No, exams are done face to face on the established date. There will not be any virtual exams either.